

# Sound Anchors Compact ADJ

## Instructions



Sound Anchors

2835 Kirby Cir NE Unit 110

Palm Bay, FL 32905

321-724-1237

[Office@soundanchors.com](mailto:Office@soundanchors.com)

[www.soundanchors.com](http://www.soundanchors.com)

## SOUND ANCHORS COMPACT ADJUSTABLE SPEAKER STANDS

Thank you for choosing Sound Anchors stands for your studio. We believe that you will find them to be a valuable tool that will help you to hear subtle differences more easily and make better recordings. Please take the time to carefully read these instructions before assembling your stands, and you will be more than satisfied with their performance for many years to come. The hardware for this stand is very similar to the standard ADJ1 and ADJ2. The only difference is it uses 2 supporting bolts for the arm mount as opposed to 1.

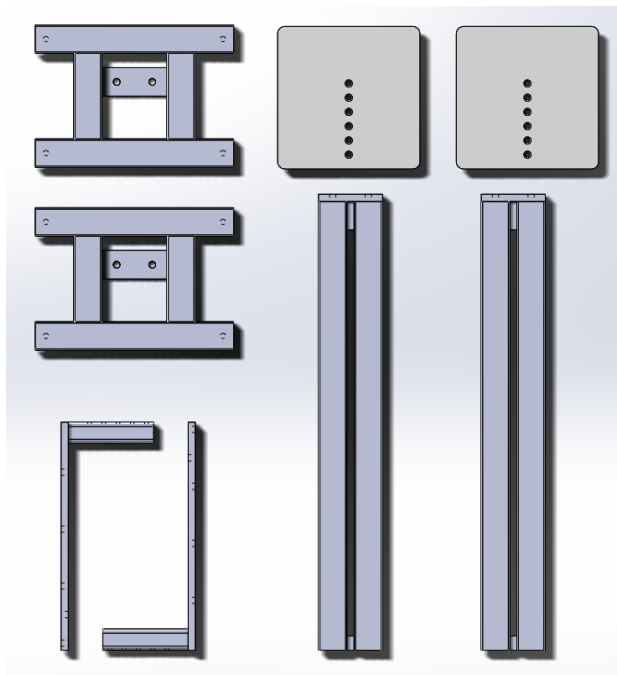

### Hardware Inventory:

- 8ea – 3/8-16 spikes
- 8ea – 3/8-16 jam nuts
- 8ea – 3/8 flat washers
- 8ea – Blue Dots
- 4ea – ¼-20 x 5/8 Flat Head Screws
- 4ea – 7/16-14 x 1 Flat Head Screws
- 4ea – 7/16-14 x 2.5 Socket Head Screws
- 4ea – 7/16 Black Hardened Washers
- 1ea – 5/32 Hex wrench
- 1ea – ¼ Hex Wrench
- 1ea – 3/8 Hex Wrench

### Compact ADJ Parts List

- 2ea – Comp ADJ Bases
- 2ea – 32" Uprights
- 2ea – 10 x 10 Platforms
- 2ea – "L" Shaped mounting Arm

The parts listed are for a "Standard" version of the Compact Adjustable stands. We are able to accommodate custom sizes for all of the parts, but that may increase the price and production time. If there are custom options you think you need, give us a call at 321-724-1237 and speak with Bernie or Mark. We are more than happy to talk though what you may need to work for your specific application.

Assembly:

1. Fasten the base to the upright using 2ea 7/16-14 x 1 Flat Head Screws, as shown in figure 1.

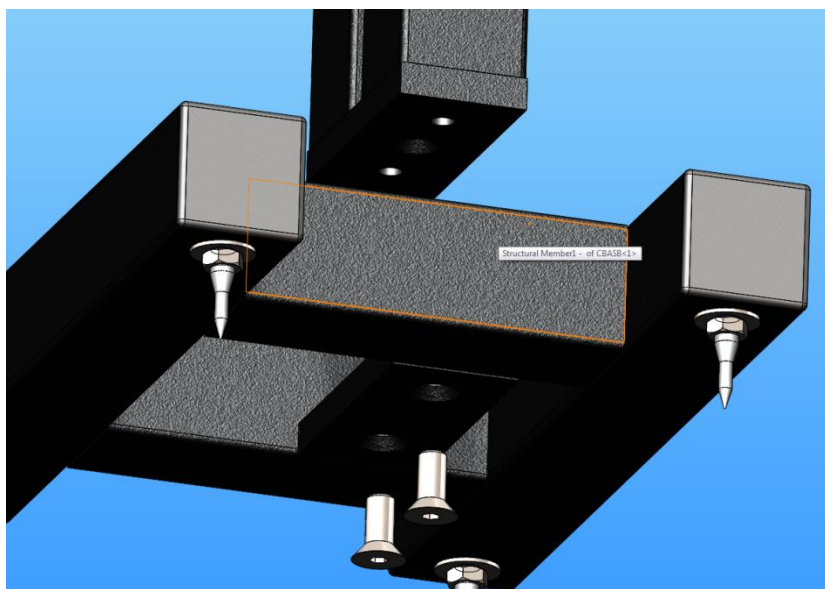

Figure 1

2. Install spikes, washers, and jam nuts into the four threaded holes in the stands base. Insert the spikes so that there are 1 or 2 threads visible after the jam nuts are set. JAM NUTS ARE FINGER TIGHTEN ONLY. NO TOOLS.

3. To fasten the "L" Shape Arm to the upright, use 2ea 7/16-14 x 2.5 Socket Head bolts and 2ea 7/16 Black Hardened washers, as shown in Figure 2. The screws will be inserted from the front of the stand and threaded into the mounting arm that is mounting to the back of the upright. This will orient the above arm over the upright giving a centered position on the stand.



Figure 2

4. After determining the location where you will be setting up your stands, it is time to adjust their level. With the stand in its operational position in the room, place a magnetic torpedo level vertically on the front face on the upright. Tighten the jam nuts with a 9/16 wrench when the stand is level.
5. Adjust the platforms to the desired height.
6. Remove protective coating from both sides of the Bluedots. Place one Bluedot on each corner of the platforms.
7. Place the speaker on the platform centered with the stand.

## **Compact Adjustable Stand**

Real estate behind your console is a very key factor in figuring out the placement of equipment in your studio. The Compact Adjustable stand gives you a smaller footprint with the center mounted style, as opposed to the cantilevered design of the normal ADJ stands. With this, it is much easier to fit a pair of speakers in your work space to maximize the performance and get the desired result from your work. The Compact Adjustable is made from the same rigid material as our tried and tested ADJ1 and ADJ2 stands. You do lose some of the adjustability range, but as long as you know the desired height within 3 or 4 inches give or take, this stand can work wonders for you. Thank you again for choosing Sound Anchors to really bring out your audio equipment.